

88 5181 25

A&C Recliner Table

Black Finish

IMPORTANT NOTE

Carefully remove all the parts from the carton and put them individually on a soft cloth to prevent scratches or other damages occurring to the wood parts.

We have taken great care in the design of this product and request that you carefully and strictly follow our assembly instructions to ensure a completed product as it was designed.

Home Styles

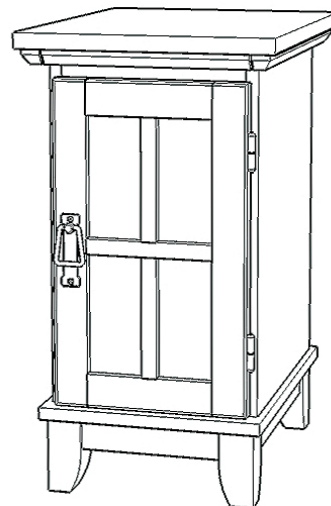

Part List

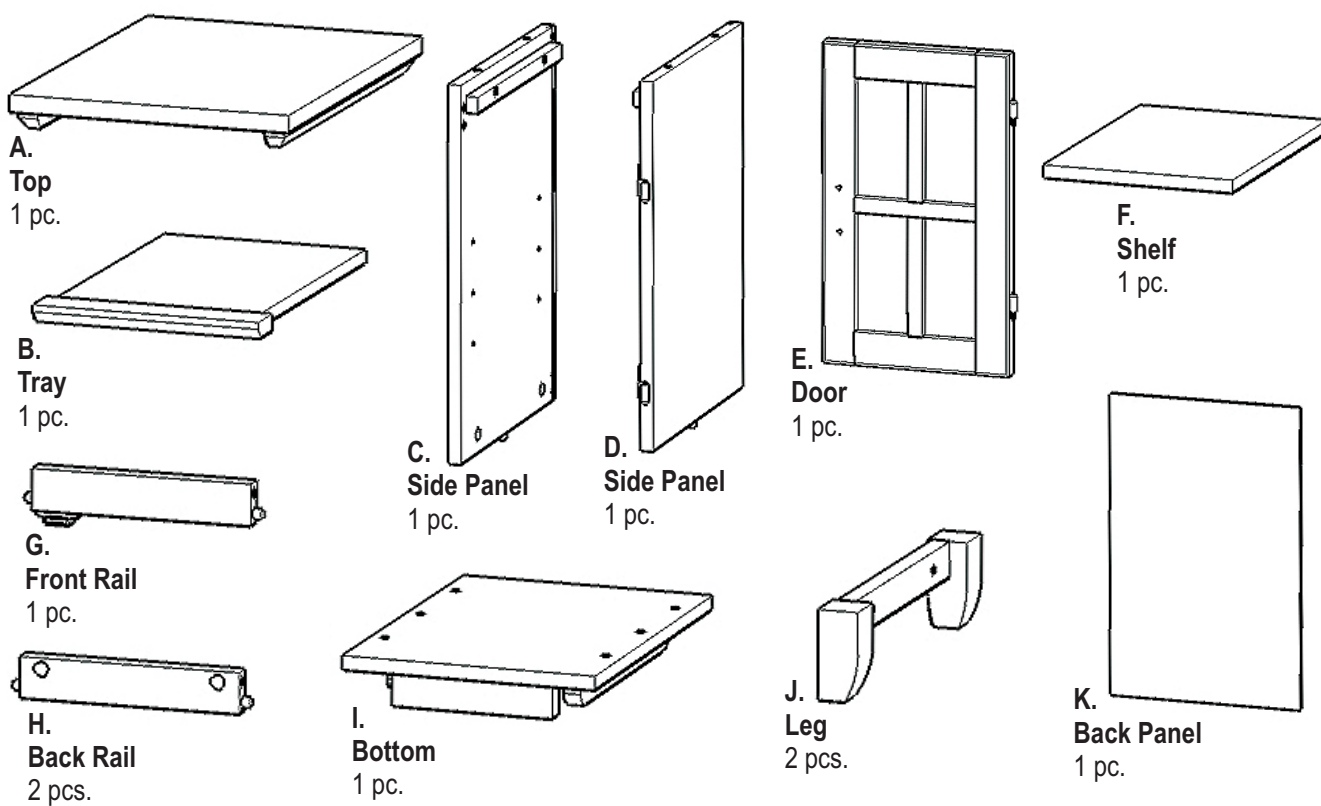

Hardware List

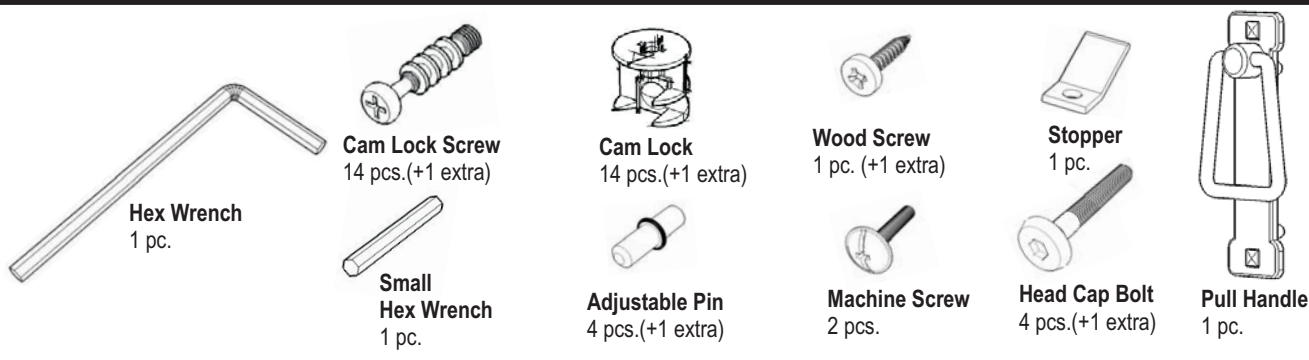

Tools required for assembly : **Phillips** screwdriver

Home Styles Consumer Assistance Line 888-680-7460 and 877-831-0319
servicedesk@homestyles-furniture.com

Assembly Instructions 2/3

IMPORTANT

Please keep Hex Wrench in a safe place as you may need to tighten up the Head Cap Bolts in the future.

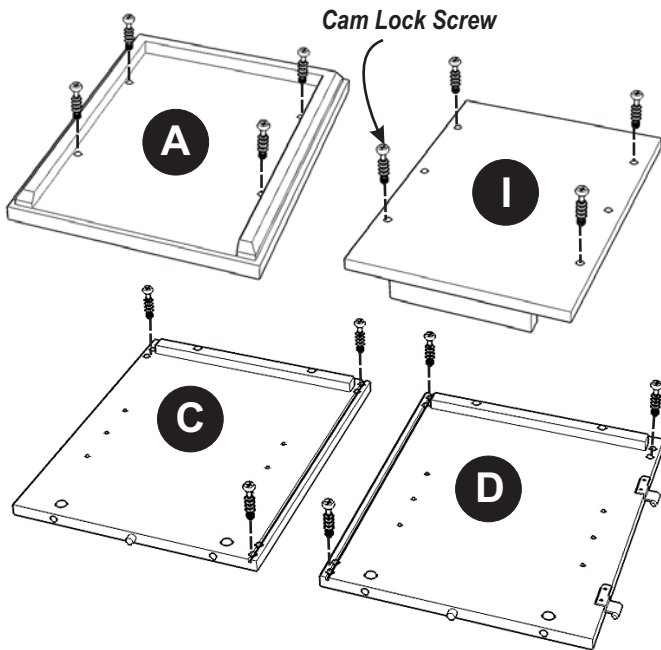

STEP 1

Put Cam Lock Screws into the pre-drilled holes of Top (A) Side Panel (C), (D) and Bottom (I) and tighten. (See figure 1)

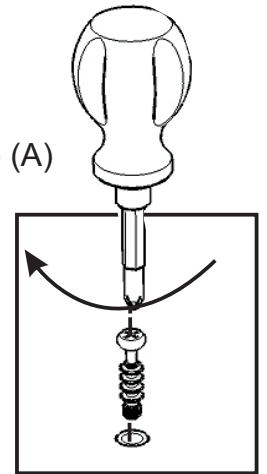

STEP 2

Attach Leg (J) to the Bottom (I) with Head Cap Bolts. (See figure 2)

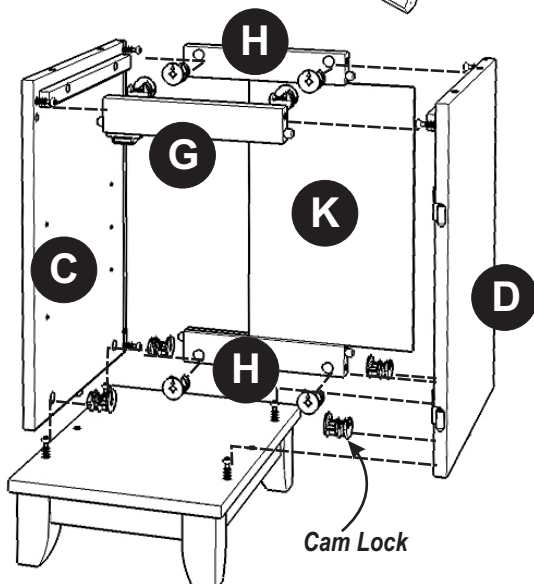
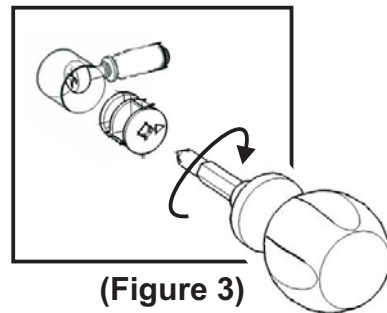
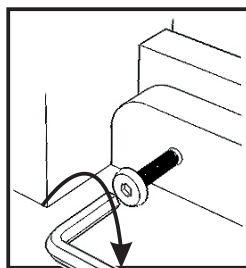
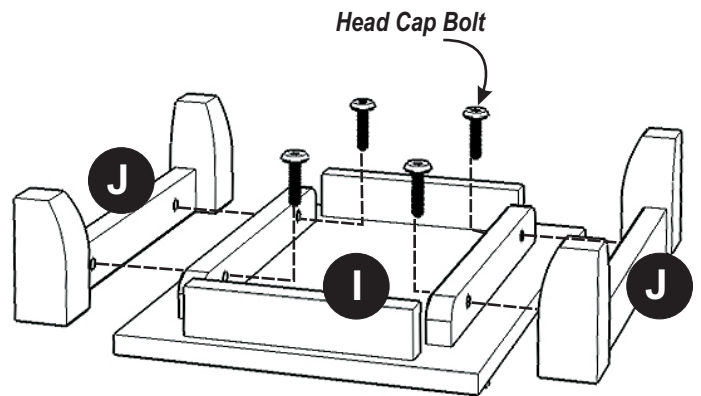

STEP 3

Attach Back Rail (H) to the Side Panel (C) with Cam Locks. (See figure 3)

Slide Back Panel (K) into place.

Attach Front Rail (G) to the Side Panel (C) with Cam Lock.

Attach Side Panel (D) to the unit with Cam Locks.

Attach unit to Base unit with Cam Locks.

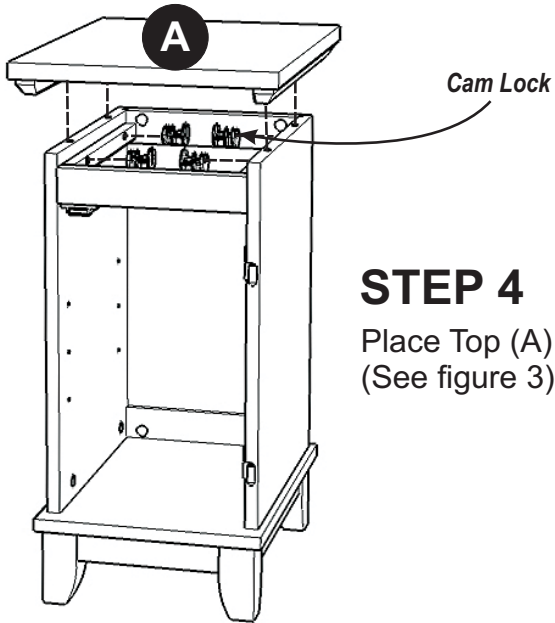

STEP 4

Place Top (A) onto the unit with Cam Locks.
(See figure 3)

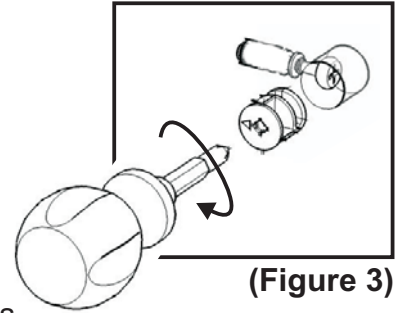

(Figure 3)

STEP 5

Slide Tray (B) into place.

Assemble Stopper to Tray (B) with
Wood Screw.
(See figure 4)

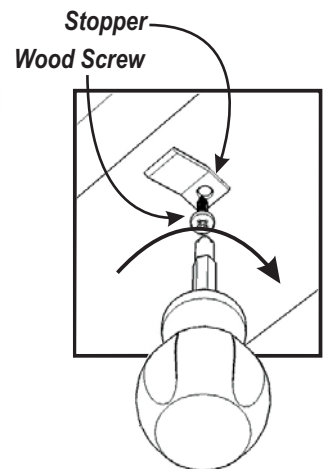
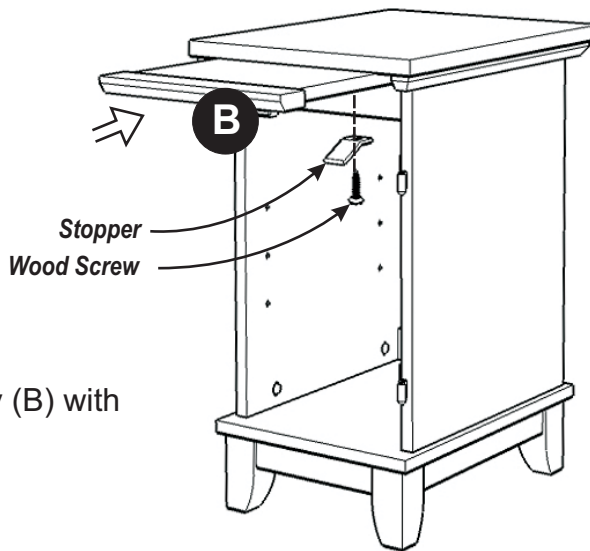

(Figure 4)

Adjustable Pin

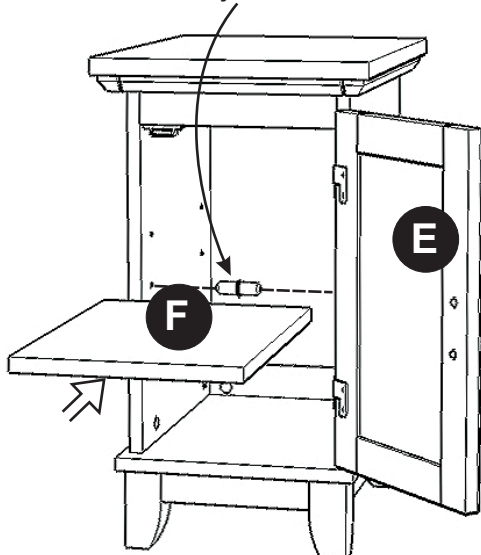

STEP 6

Insert Adjustable Pin into Side Panels
at the desired level.

Slide Shelf (F) into place.

Attach Door (E) to the Side Panel
by sliding the door lift hinges into
the side panel hinges. (See figure 5)

Assemble Pull Handle to Door (E)
with Machine Screws. (See figure 6)

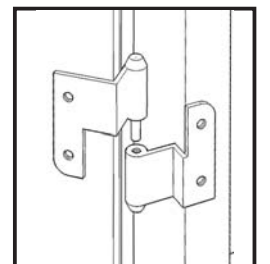

(Figure 5)

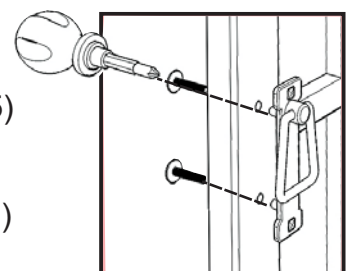

(Figure 6)