

88 5300 309 Premium Buffet of Buffet Large Hutch Natural Maple Finish

IMPORTANT NOTE

Carefully remove all the parts from the carton and put them individually on a soft cloth to prevent scratches or other damages occurring to the wood parts.

We have taken great care in the design of this product and request that you carefully and strictly follow our assembly instructions to ensure a completed product as it was designed.

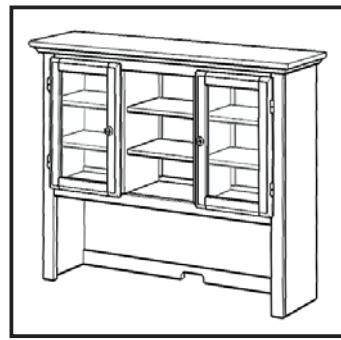

Hutch Unit

*Home
Styles*

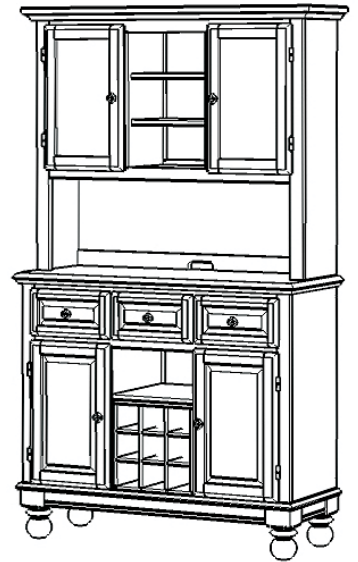

Part List

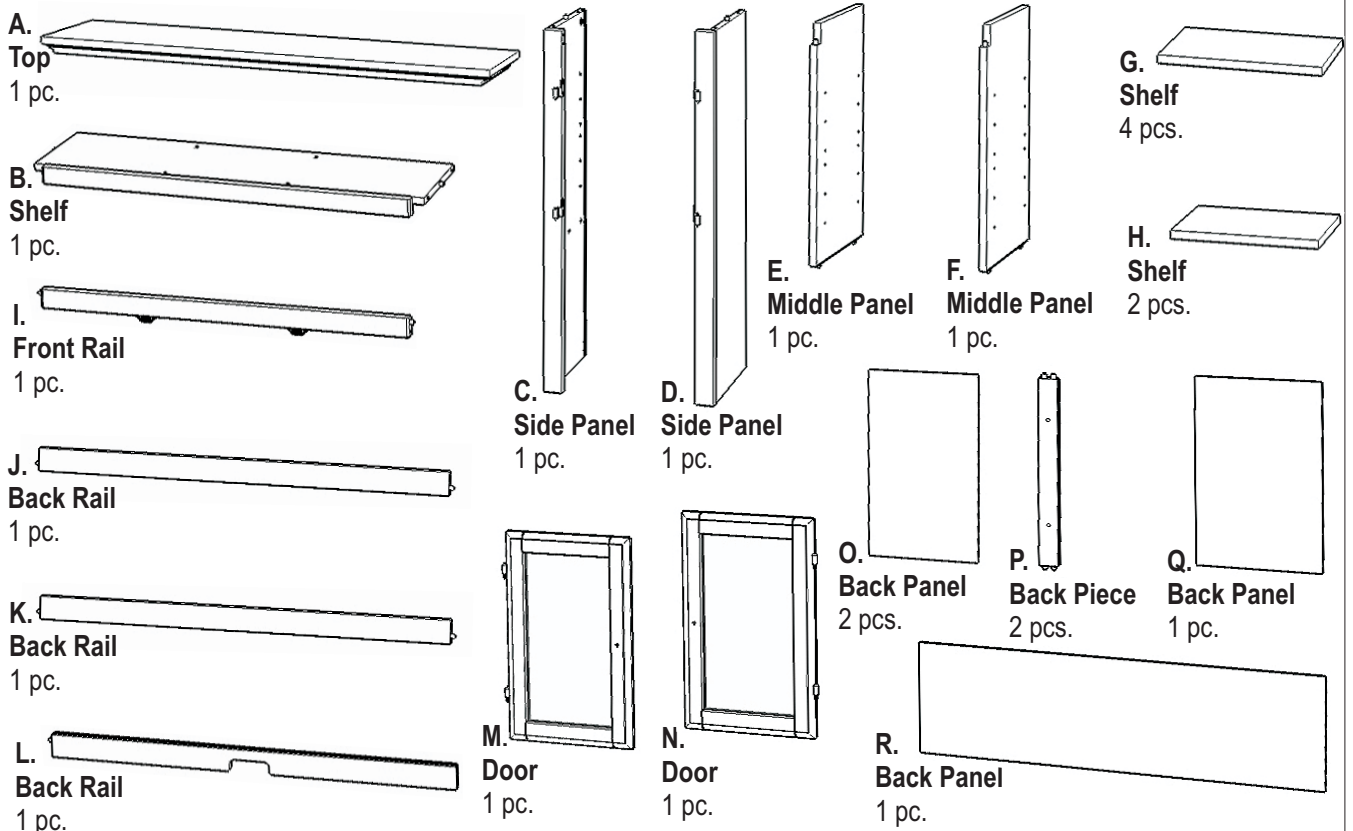

Hardware List



Cam Lock Screw
16 pcs.(+1 extra)

Cam Lock
16 pcs.(+1 extra)

Adjustable Pin
24 pcs.(+2 extra)

Wood Screw
20 pcs. (+1 extra)

Steel Plate Connector
2 pcs.

Machine Screw
2 pcs.

Pull Handle
2 pcs.

Tools required for assembly : **Phillips** screwdriver

Home Styles Consumer Assistance Line 888-680-7460 and 877-831-0319
servicedesk@homestyles-furniture.com

STEP 1

Put Cam Lock Screws into the pre-drilled holes of Side Panels (C),(D) and Top (A) and tighten. (See figure 1)

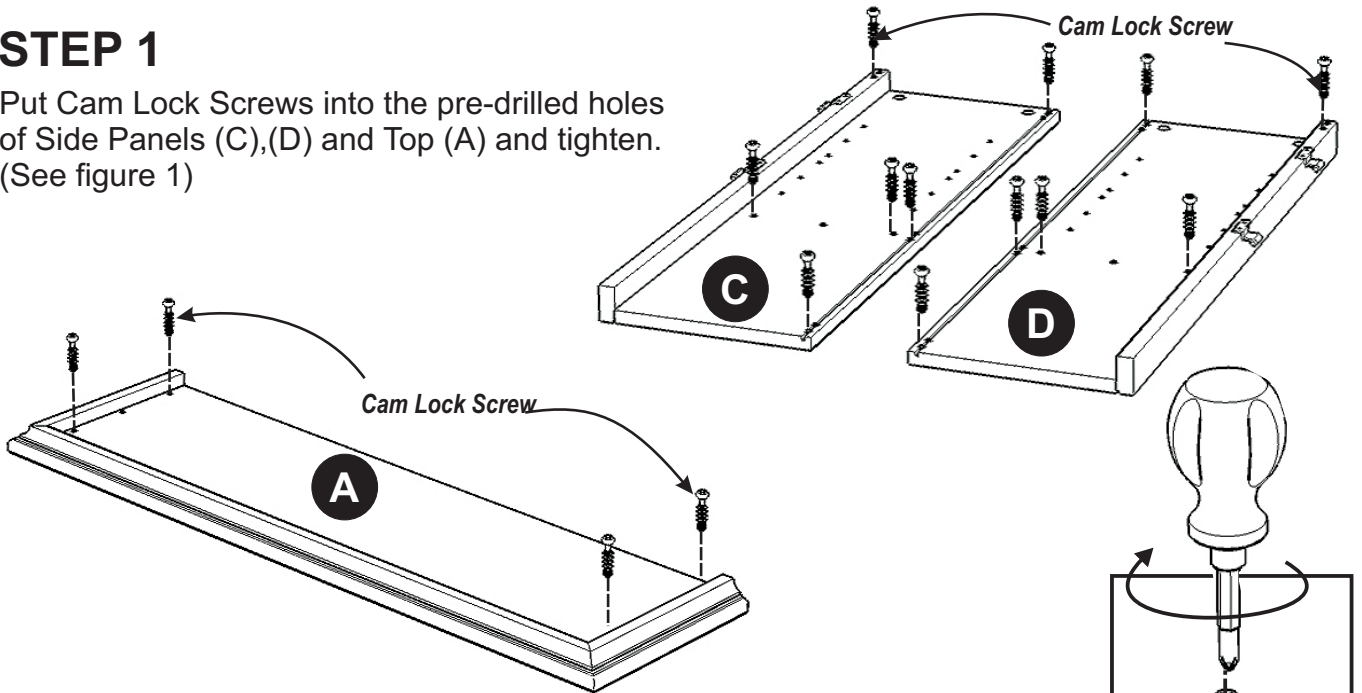

(Figure 1)

STEP 2

Attach Back Rail (L) and (K) to Side Panel (C) with Cam Lock. Slide Back Panel (R) into position.

Attach Back Piece (P) to Back Rail (K) and slide Back Panels (O) and (Q) into position.

Attach Back Rail (J) to the unit with Cam Lock.(See figure 2)

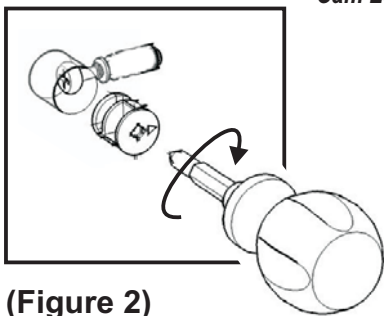
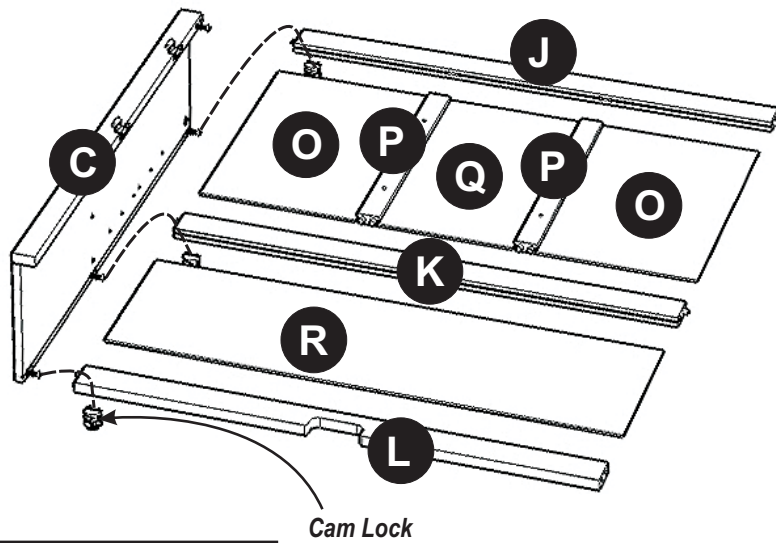

(Figure 2)

STEP 3

Attach Shelf (B) to the unit with Cam Locks.

Attach Middle Panel (E), (F) to the unit .

Attach Front Rail (I) to the unit with Cam Lock.

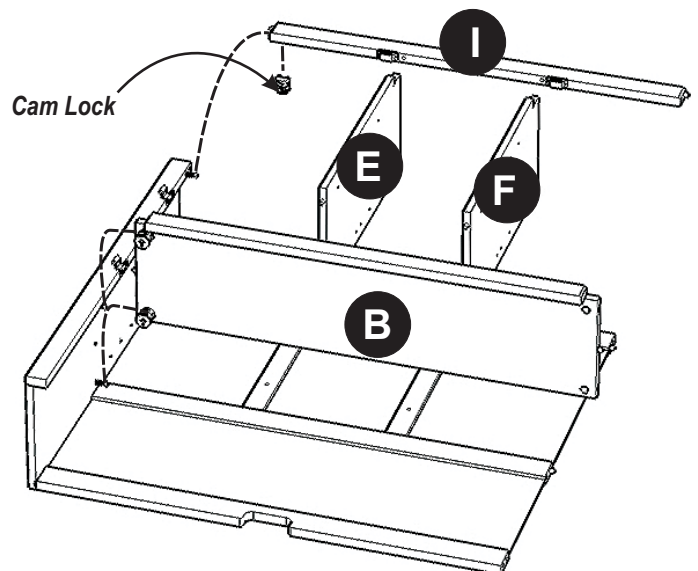

STEP 4

Attach Side Panel (D) to the unit with Cam Locks.

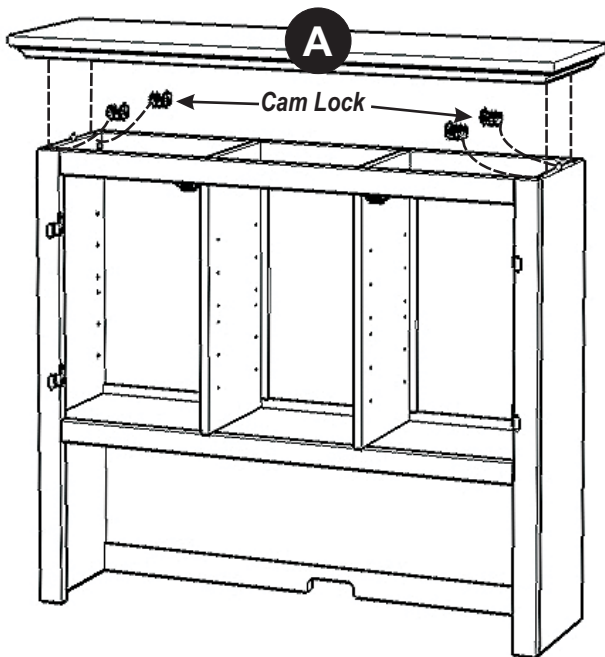
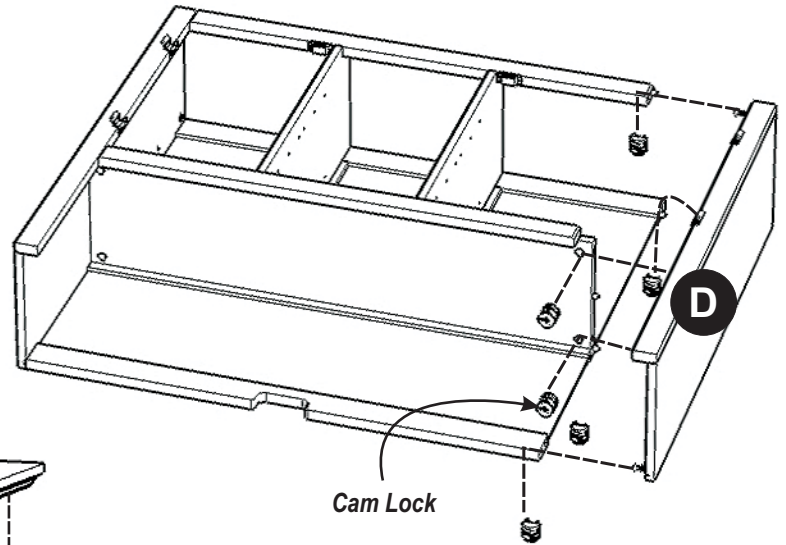

STEP 5

Turn the unit to its' upright position.

Place Top (A) onto the unit, using Cam Locks.

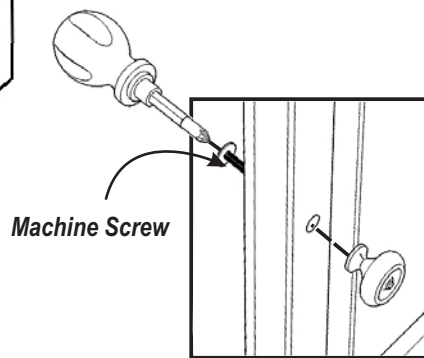

(Figure 3)

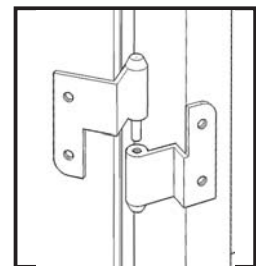

(Figure 4)

STEP 6

Insert Adjustable Pins into side panels and middle panels at the desired level.

Slide Shelves (G) and (H) into position.

Assemble Pull Handles to Doors (M) and (N) with Machine Screws.(See figure 3)

Attach Door (M) and (N) to the side panels, by sliding the door lift hinges into the side panel lift hinges.(See figure 4)

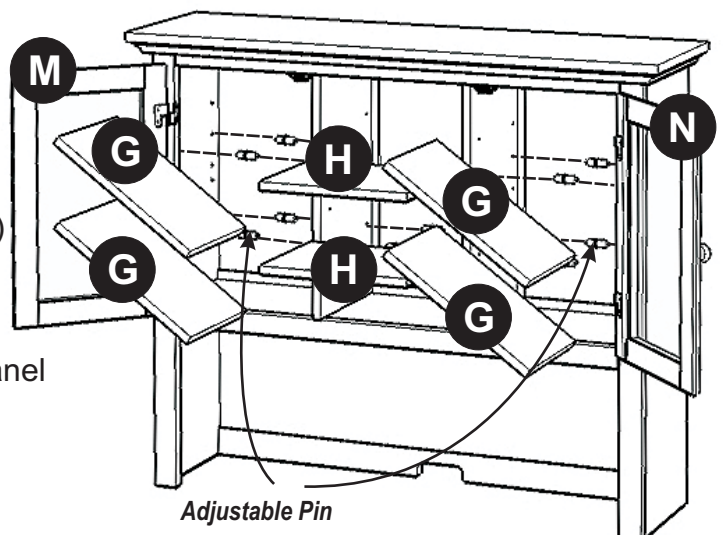

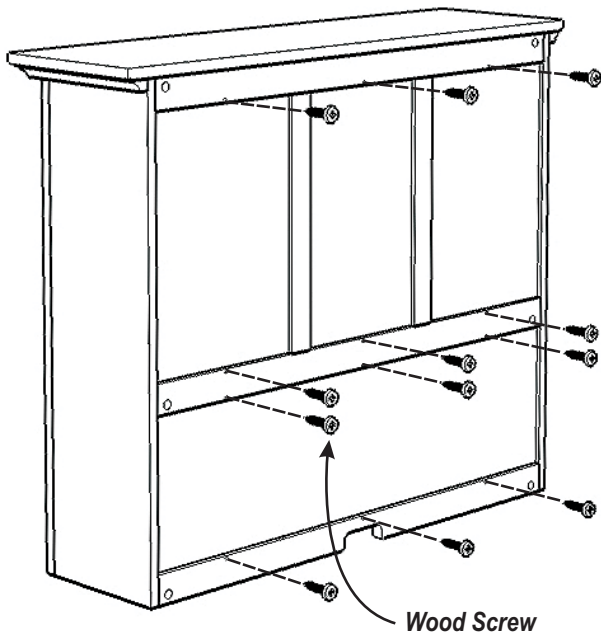

Wood Screw

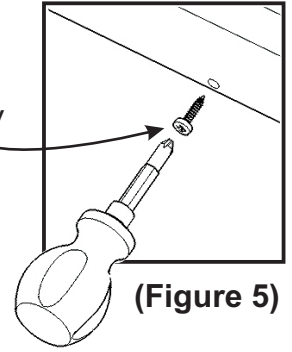

(Figure 5)

STEP 7

Insert 12X Wood Screws into the back of the unit, tighten up all the Wood Screws. (See figure 5)

Note: Please make sure unit is level before tightening these screws.

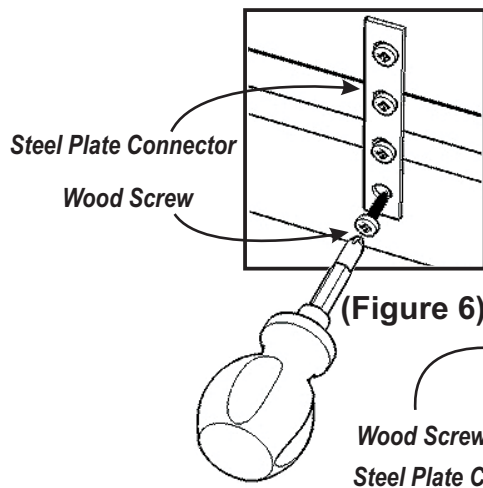

(Figure 6)

Wood Screw
Steel Plate Connector

STEP 8

Place the Hutch unit onto the Buffet unit.

To attach the Hutch to the Buffet, attach Steel Plate Connectors, using Wood Screws and tighten. (See figure 6)

